



Push Button Installation - Ledge and Dive

Revised push button installation

Revised installation reduces the possible twist between the screws and the handle when mounting thus stopping the button sticking

Sleeves fitted to handle

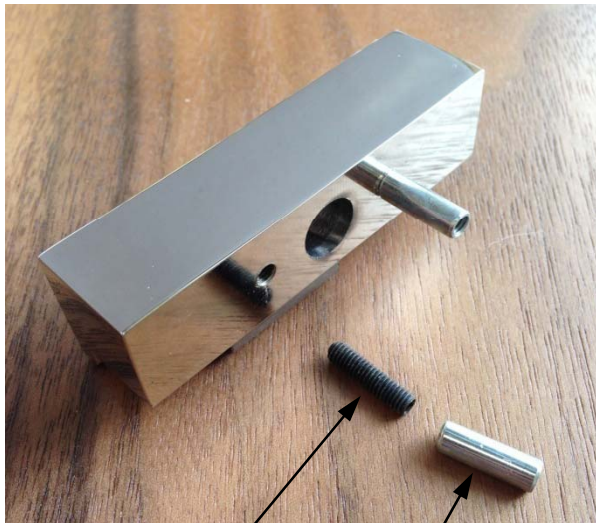

M4 x 16mm grub screws

Internal M4 threaded sleeves x 15 long

Cross section showing sleeve mounting

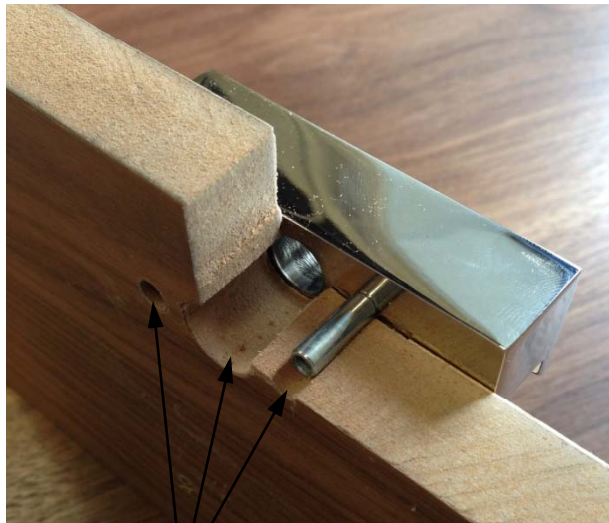

Revised cabinet drilling detail,
see page 2 for dimensions and template

Cross section showing assembled handle



Shorter M4 button head screws

MR140402



Push Button Installation - Ledge and Dive

Block Keep and Strike Plate options

Block Keep



Turnstyle Designs preferred specified option

Strike Plate



MR140402



Push Button Installation - Ledge and Dive

Revised drilling details

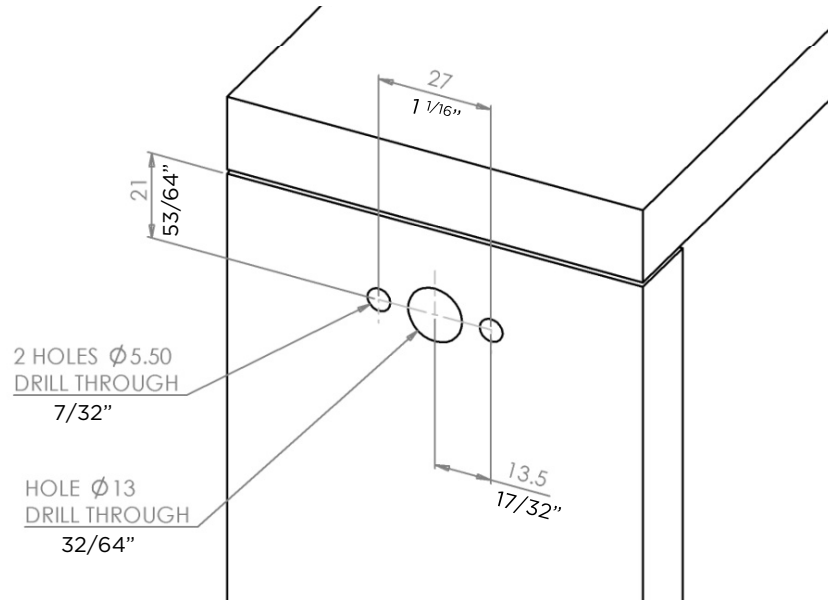

Please note:
The height from the top of the door/drawer front to the drilling detail (shown above) is only suitable when the front is flush fitting to the carcass as shown in the diagram

Please set out handle and latch before drilling

Drilling template

Door/drawer edge
See note below

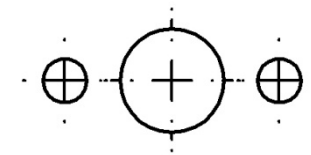

Scale 1:1
Line length 50mm / 1 31/32"

MR140402