

Below is a description of the standard lever handle configurations. Although illustrated on round roses the same configurations are available for levers on square roses and back plates\*.

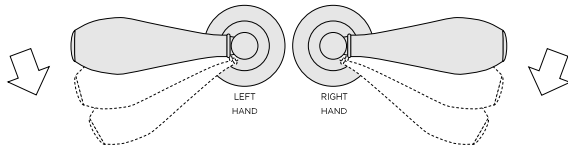

#### PASSAGE PAIR (SPRUNG)

Lever handles return to the horizontal position by means of sprung roses / back plates. Set consists of two lever handles mounted on roses or plates, 8 x 8 x 110mm piercing spindle, M4 x 60mm through bolts (rose options only), all necessary mounting bolts, fixings and instructions.

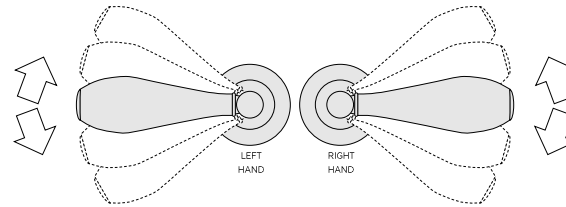

#### MULTI-POINT PAIR (UN-SPRUNG)

Lever handles are lifted up to engage bolts and depressed to retract bolts and latch. Set consists of two lever handles mounted on roses or plates, 8 x 8 x 110mm piercing spindle, M4 x 60mm through bolts (rose options only), all necessary mounting bolts, fixings and instructions.

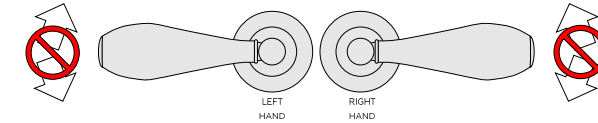

#### FIXED DEAD PAIR

Lever handles are fixed in the horizontal position and act as push / pull handles only, they do not operate any form of mechanism. Set consists of two lever handles mounted on roses or plates, 8 x 8 x 110mm piercing spindle, M4 x 60mm through bolts (rose options only), all necessary mounting bolts, fixings and instructions.

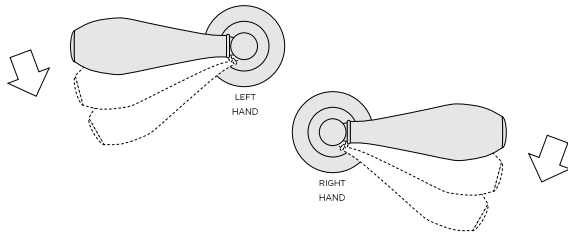

#### SINGLE LEVER (SPRUNG)

Lever handle returns to the horizontal position by means of sprung roses / back plates. Set consists of single lever handle mounted on rose or plate, face fixing wood screws, all necessary mounting bolts, fixings and instructions. Lever handing must be specified.

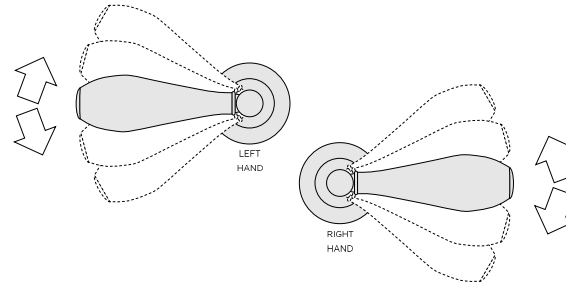

#### SINGLE MULTI-POINT LEVER (UN-SPRUNG)

Lever handle is lifted up to engage bolts and depressed to retract bolts and latch. Set consists of single lever handle mounted on rose or plate, face fixing wood screws, all necessary mounting bolts, fixings and instructions. Lever handing must be specified.

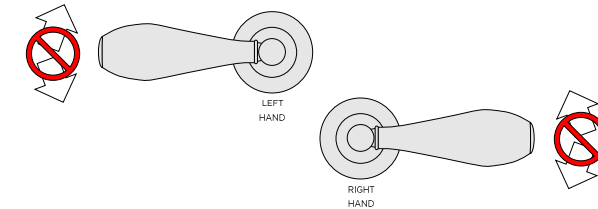

#### SINGLE FIXED DEAD LEVER

Lever handle is fixed in the horizontal position and acts as a push / pull handle only, it does not operate any form of mechanism. Set consists of single lever handle mounted on rose or plate, face fixing wood screws, all necessary mounting bolts, fixings and instructions. Lever handing must be specified.

#### PUSH BUTTON PRIVACY SET (SPRUNG)

Lever handles return to the horizontal position by means of sprung roses / back plates. Set consists of two lever handles mounted on roses or plates (rounded or rectangle plates only), 60mm backset tubular privacy latch, 8 x 8 x 115mm split spindle, M4 x 60mm through bolts (rose options only), all necessary mounting bolts, fixings and instructions.

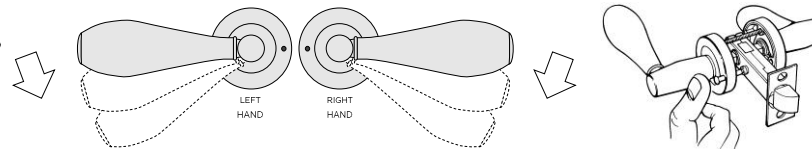

\* Levers on fineset plates are always supplied un sprung.